

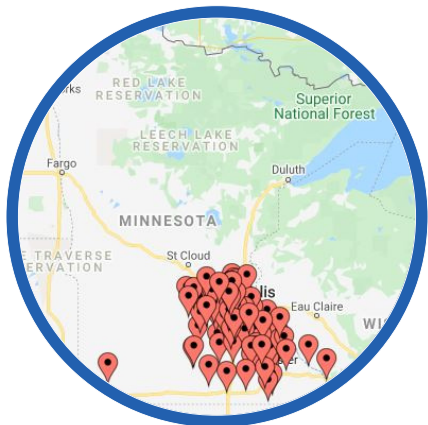

## Regional Impact

John Burch Park hosts many different communities throughout Southeastern Minnesota. There are over 113 Teams from around the region which represent over 80 towns and cities. High school, Legion, VFW, Amateur baseball teams during the spring and summer as well as JV and Varsity football games in the fall are all hosted by this magnificent park. State Amateur Baseball Tournaments have been hosted here as well.



John Burch Park

Highway 19/Main Street W and 7th St., Cannon Falls, MN 55009

## Community

Cannon Falls has a town population of 4,220 and is strategically placed in between the Twin Cities, Rochester, Northfield and Red Wing. One of the treasures of Cannon Falls sits in the center of the town. John Burch Park is one of Cannon Falls' most recognizable parks with the large baseball field that is home to the Cannon Falls Bombers High School baseball team, Cannon Falls Bears and various Legion and VFW teams throughout the summer. The fall season sees John Burch field transition to a football field to host Bomber football games under the lights. Another highlight of the park is the band shell which is occasionally used for various events during the summer and fall months.

Open Camera App and scan for an electronic version of this brochure.



# JOHN BURCH *Park*



# The Limestone Wall

Original construction started in 1937 by the Works Progress Administration (WPA) and the retaining wall was completed in 1938 by the Civilian Conservation Corp (CCC) utilizing locally sourced limestone.

Through the years erosion has caused the limestone to deteriorate compromising the integrity of the wall. Sitting atop the wall is concrete tiered seating which has now been compromised and has become a safety hazard. The new construction plan would replace the limestone wall with a cast in-place reinforced concrete wall which would also incorporate a new 1st base dugout.



**LEANING**



**EROSION**



**UNSTABLE**

# Facts About John Burch Park

- Rated one of the "Best Amateur Baseball Stadium in Minnesota" by WCCO (2011)
- Featured in Town Ball Parks of Minnesota by author Todd Mueller (2016)
- Ranked #15 of Minnesota Ballparks by Minnesota Amateur Baseball Enthusiast Bob Greeley (2020)
- Received a Fanfare Score of 3.43 out of 5 from Stadium Journey
- A Stop on the Fox 9 News Townball Tour 2018

## The Ask

Bonding request is for \$469,000 in state funds to rehab the 1938 limestone retaining wall, construct a new 1st base dugout and update the seating area that sits atop the retaining wall and install a safety railing and fencing in front of the seating area.

The City of Cannon Falls and the nonprofit John Burch Park Supporters are committed to matching 50% of the estimated total project cost of \$938,000.

Your time and attention to the John Burch Park project and the City of Cannon Falls and its residents and athletes is greatly appreciated.

*Thank you!*

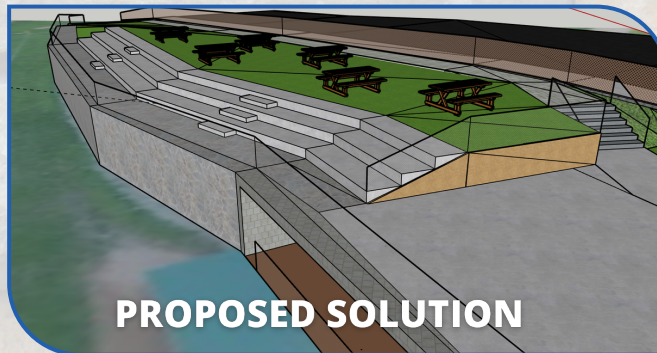

**PROPOSED SOLUTION**

# The Seating

The cement tiered seating area has been part of the charm of the ball park through over the years. "Fill the hill" has been the phrase for promoting the big games in the community. Due to the erosion of the retaining wall, the cement seating has started to crack, shift and slant causing tripping hazards and it also leans toward the safety fence of the retaining wall. There are also no railings for spectators to hold onto for stability. The proposed plan for the seating would be to remove and replace with new concrete tiered seating with new poured concrete seating with a decorative iron railing. There would also be more space at the very top dedicated to ADA accessibility.



**SHIFTING**



**LEANING & CRACKING**